

GRACE VASOMULTI® SENZABRIDA®

GR003BI

CE EN 997:2015



Drain 4/2,6 lt

Cod. **GR003BI**

Floor mounted Wc No Rim 52.36 h43 cm. with adjustable water inlet/outlet MULTI . Back to wall installation. Drain 4 / 2,6 Lt. Fixing kit included. Weight 26 Kg

GLOBO

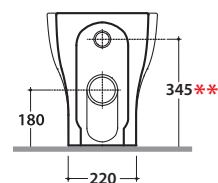
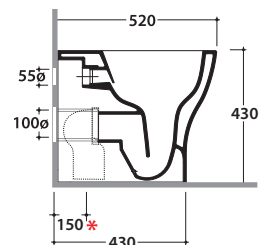
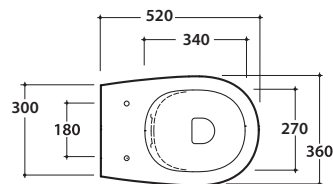

Seat-cover with hinge system to quick release



Antibacterial treatment on toilet seats in shiny white

Cod. **GR022BI**

Removable duroplast seat-cover with soft-closing system. Weight 2 Kg

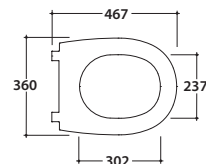
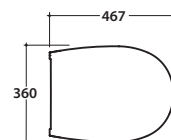

Cod. **VA077 ***

Elbow pipe for floor drain. Adjustable 6/11 cm. Weight 0,3 Kg



Cod. **VA079 ***

Elbow pipe for floor drain. Adjustable 12/15 cm. Weight 0,3 Kg



Cod. **VA078 ***

Elbow pipe for floor drain. Adjustable 16 / 20 cm. Weight 0,3 Kg



Cod. **VA086 ****

Eccentric pipe for water inlet 33/36cm. Weight 0,1 Kg



Cod. **VA076**

Pipe for wall drain 35cm.



Cod. **VA132**

Flow reducer.

